



▶ A leading die casting tool maker

RASEM is one of the leading tool manufacturers in the die casting industry, specializes in aluminum injection form and trim tools. It was founded by Zeynel Gün in 1993 in Istanbul.

Rasem combines new technology, engineering knowledge and designing talents focusing on "customer satisfaction". Concerning only with the production of cold chamber HPDC tools for the last 17 years is what underlies Rasem's success in the molding industry.

Today, Rasem is capable of producing tools; up to 2000 mm in size and up to 15 tons in weight in 1,300 m2 closed area.

Rasem comprehends the necessity of investment in people, process and technology, and works with highly qualified manpower and accumulated know-how and always pays close attention to detail.

Rasem manufactures high quality tools for mass production to OEM companies such as; *Bosch, Valeo, Magna CTS, TRW, Mahle, Stackpole, Trelleborg*, and partnering up with die casting foundries that carry on a business on 85% Automotive and rest to households and electrical-electronics industries.

With the customer-oriented culture and *Quality Assurance* mentality; Rasem has grown rapidly in the last 10 years in the domestic market, and has consequently become a valued exporter of tools to many European countries.

RASEM, with its well-educated staff with a combined 40 years of sector experience using the latest technology, produces high quality tools.

History;

- 1993 : Establishment by the first generation.
- 2001 : Focuses on cold chamber High Pressure Die Casting tools.
- 2005 : First investment on CNC technology. (by the second generation)
- 2007 : Annual production of 15 pieces of form tools.
- 2010 : More investments. Starts producing of trim tools. Annual production of 20 pieces of die casting form and trim tools.
- 2011 : Commissioning of 3D CMM device.
- 2013 : Establishment of manufacturing workshop of holding sets for tools. (Investment of CNC boring center and bridge type CNC machining center)
- 2017 : Moving to the new factory, based on 1300 m2 closed area with the new investments. Performed 42 form and 24 trim tools up to 1400 mm in size and up to 9 tons in weight with 30 employees; 11 white collars and 19 blue collars.
- 2018 : Planned to raise tool making capacity up to 25 tons until the end of this year. (Producing capacity is 50 form and 30 trim tools)



ISO 9001: 2015



RASEM is one of the leading tool manufacturers in the Die Casting industry, specializes in aluminum injection, form and trim tools.

▾ Rasem combines new technology, engineering knowledge and designing talents; focusing on “customer satisfaction.”

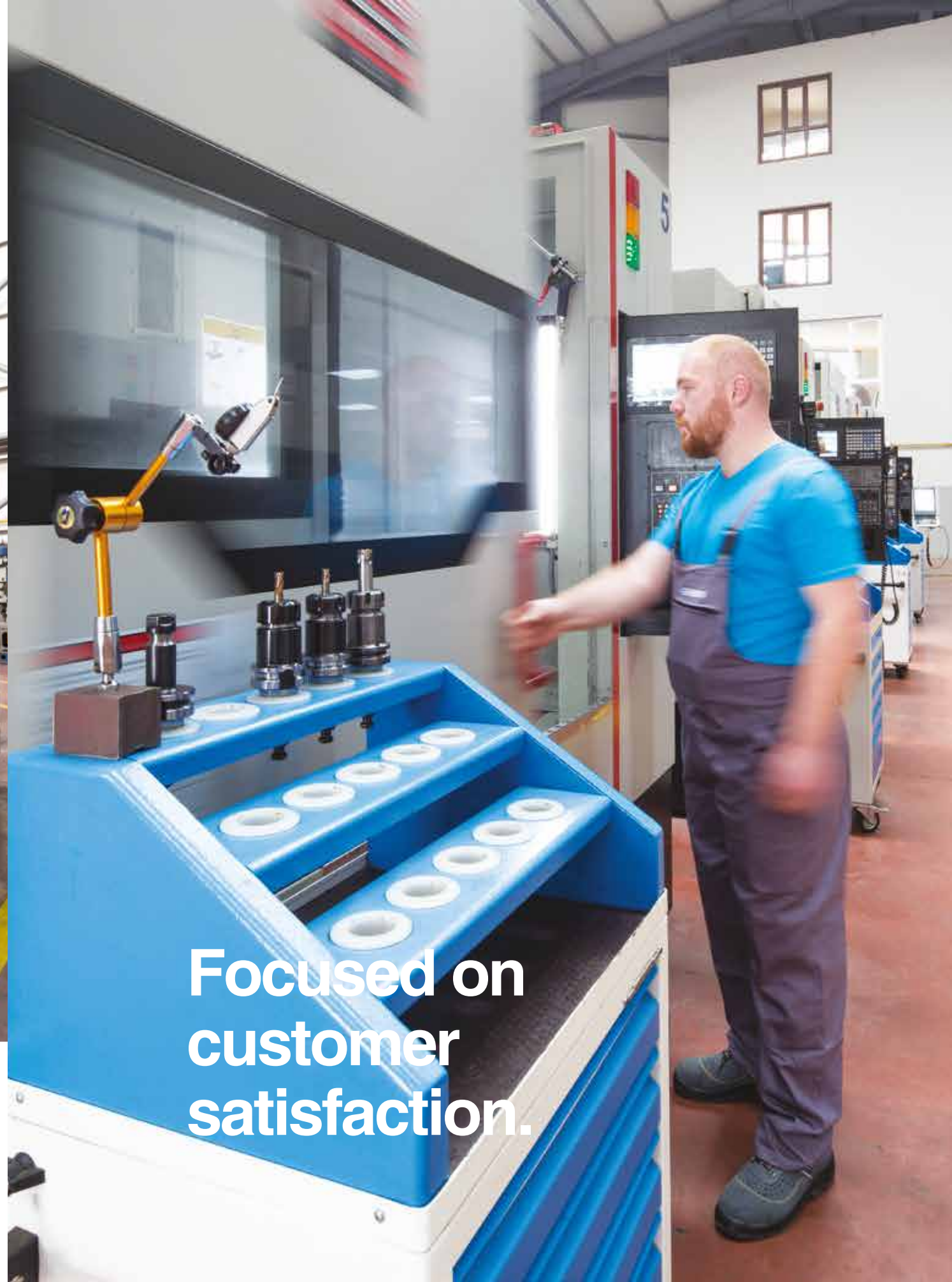

**Focused on
customer
satisfaction.**



Up to 2000 mm
in size and up to
15 tons in weight.

Today, Rasem is capable of producing tools;
up to 2000 mm in size and up to 15 tons in weight.



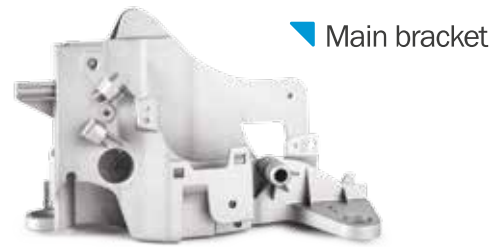
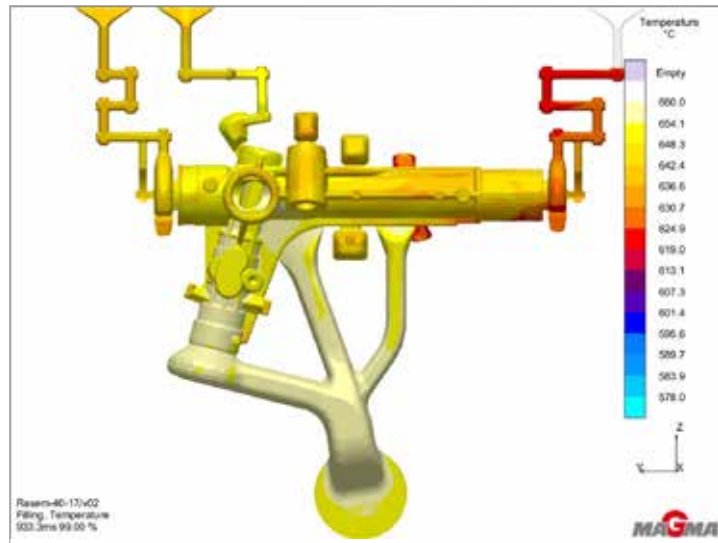

▼ Main bracket

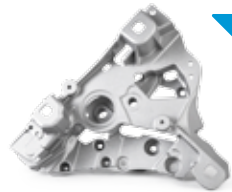

▼ Main bracket

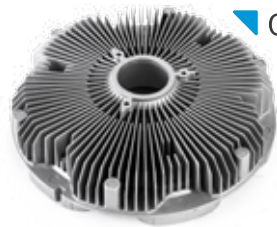

▼ Clutch body



▼ Steering column

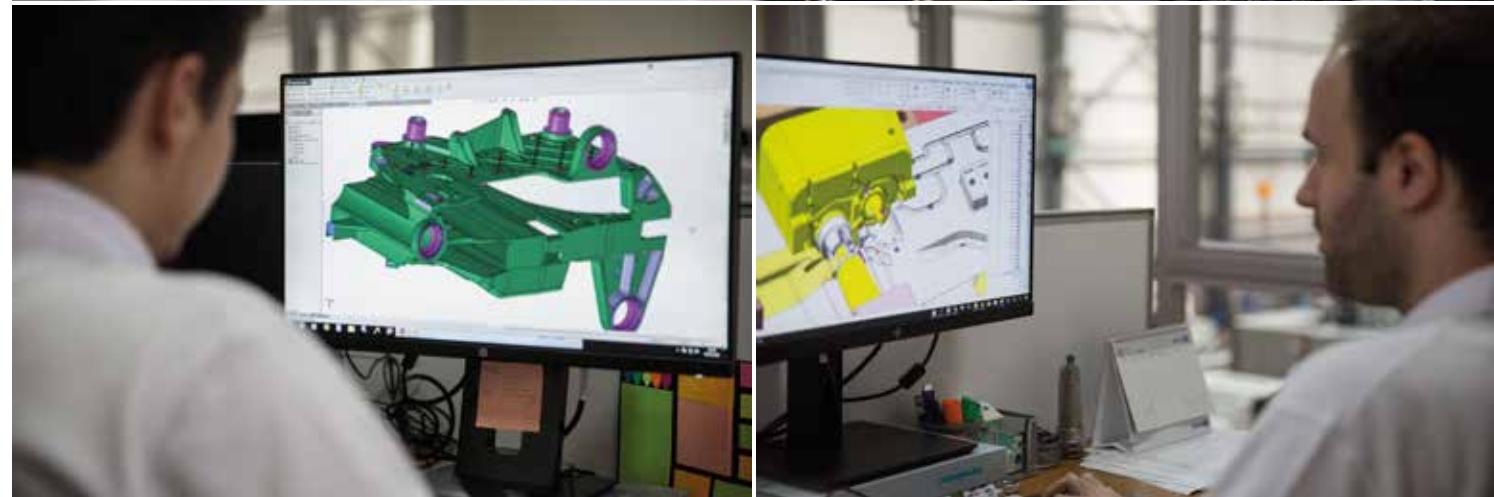

▼ Rasem comprehends the necessity of investment in people, process and technology, and works with highly qualified manpower and accumulated know-how and always pays close attention to detail.

**Qualified manpower,
know-how and
technology**

Solution Partners



▶ RASEM, with its well-educated staff with a combined 40 years of sector experience using the latest technology, produces high quality tools.

▶ Concerning only with the production of cold chamber HPDC tools for the last 17 years is what underlies Rasem's success in the molding industry.



40 years of sector experience



Only cold chamber die casting tools.



Rasem manufactures high quality tools for mass production; to 85% automotive and rest to households and electrical-electronics industries

85% of production for automotive industry

Serving Europe with customer-oriented culture

With our customer-oriented culture and *Quality Assurance* mentality; Rasem has grown rapidly in the last 10 years in the domestic market, and has consequently become a valued exporter of tools to many European countries.

Main Customers





Rasem Kalıp Basınçlı Döküm San. ve Tic. Ltd. Şti.
Tel: (+90) 262 658 86 68 Fax: (+90) 262 658 86 69
Marmara Geri Dönüşümcüler OSB
Ayçiçek Sokak No: 27 Şekerpınar TR 41420
Çayırova - Kocaeli / TURKEY

www.rasemkalip.com / info@rasemkalip.com

